

parts no.	DIM. a	DIM. b	inner thread
G	5.0	10.0	4#40
J	4.8	11.8	4#40
K	5.8	12.0	4#40

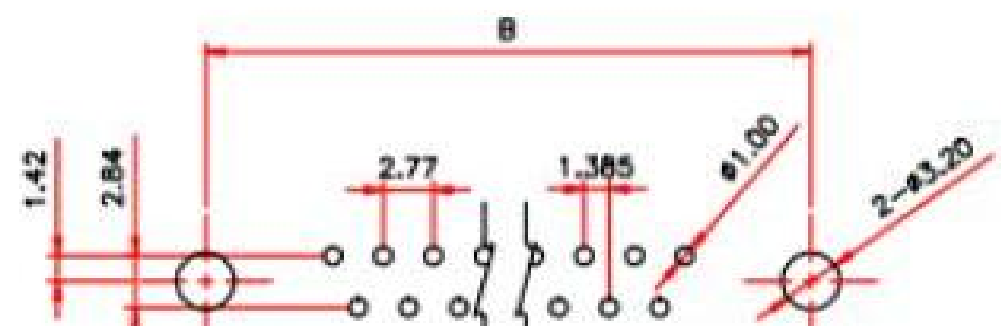
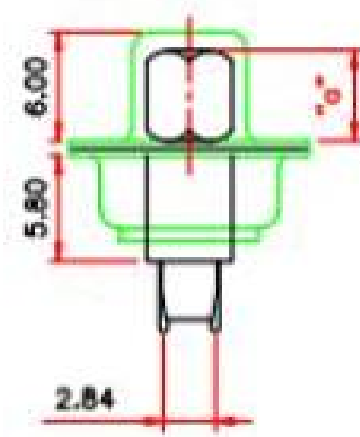
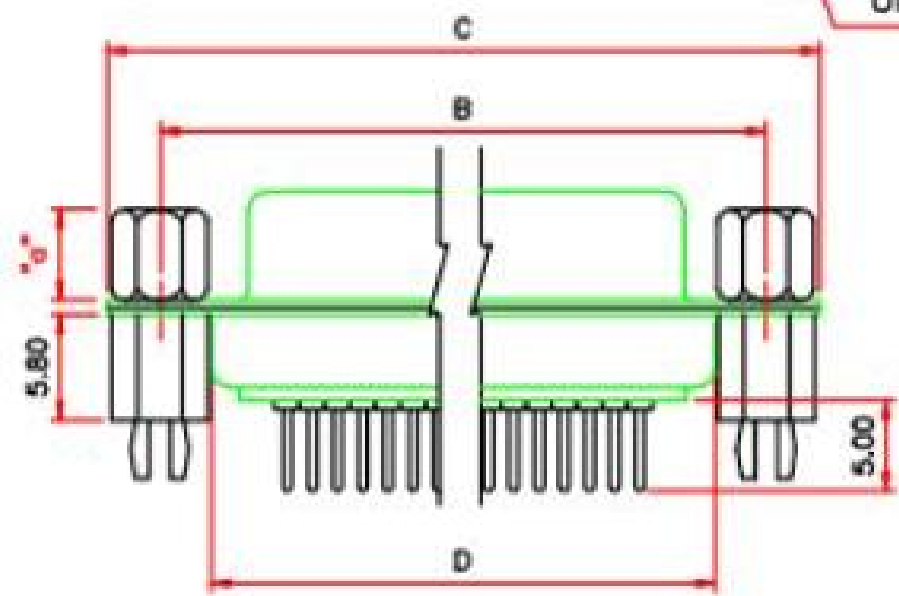

Current Rating: 3A Max  
 Contact Resistance: 30mΩ Max  
 Insulation Resistance: 3000MΩ Min  
 Voltage: 250V AC RMS for 1 Minute  
 Temperature: -40 ° C to +85 ° C

POSITION	A	B	C	D
09F	16.30	25.00	30.8	19.2